

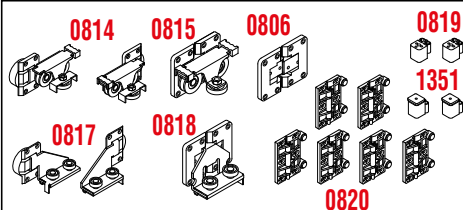

Sistemi scorrevoli per armadi / Folding systems for furniture

### KIT 0813/4 MAX 60 KG



### Legenda KIT / Kit Legend

<b>0806</b>	Cerniera centrale <i>Central hinge</i>
<b>0814</b>	Carrello superiore laterale DX-SX <i>Left hand-right hand side upper truck</i>
<b>0815</b>	Carrello superiore centrale <i>Central upper truck</i>
<b>0817</b>	Guida inferiore laterale DX-SX <i>Left hand-right hand side lower runner</i>
<b>0818</b>	Guida inferiore centrale <i>Central lower runner</i>
<b>0819</b>	Fermo superiore nylon <i>Upper nylon stopper</i>
<b>0820</b>	Cerniera Derlin a scatto <i>Derlin snap hinge</i>
<b>1351</b>	Fermo inferiore nylon <i>Lower nylon stopper</i>

### Legenda altri componenti Legend other items

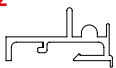
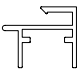
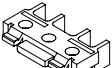
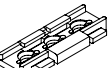
<b>0812</b>		Profilo alluminio superiore <i>Upper aluminium profile</i>
<b>0272</b>		Profilo alluminio inferiore <i>Lower aluminium profile</i>
<b>1353</b>		Supporto a scatto alto per ART.0272 <i>Lower high clip for ART.0272</i>
<b>1342</b>		Supporto a scatto basso per ART.0812 <i>Upper low clip for ART.0812</i>

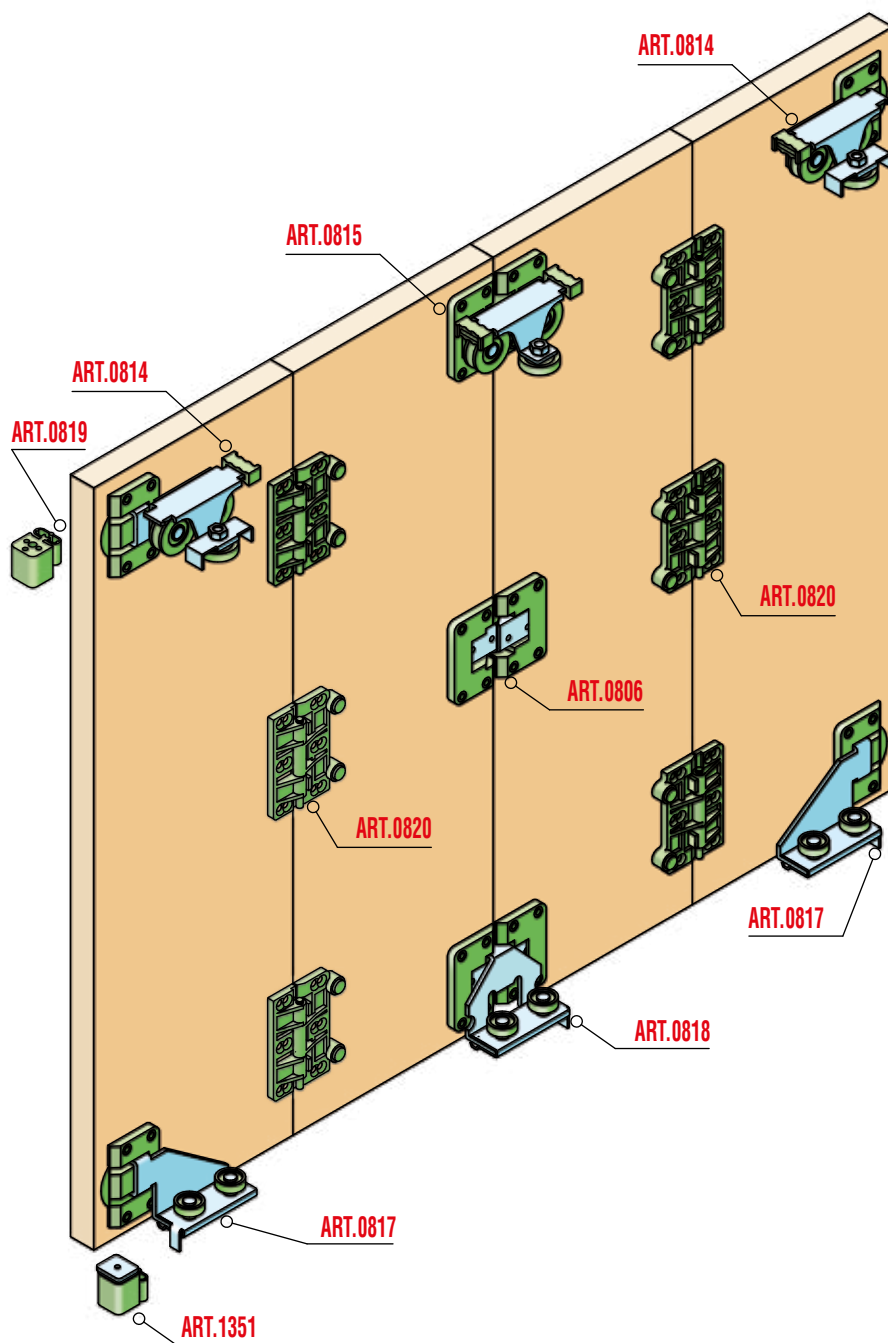

# SERIE 800 II pieghevole scorrevole

SERIES 800 The folding sliding door



Sistemi pieghevoli per mobili / Folding systems for furniture

## Sezione verticale / Vertical section

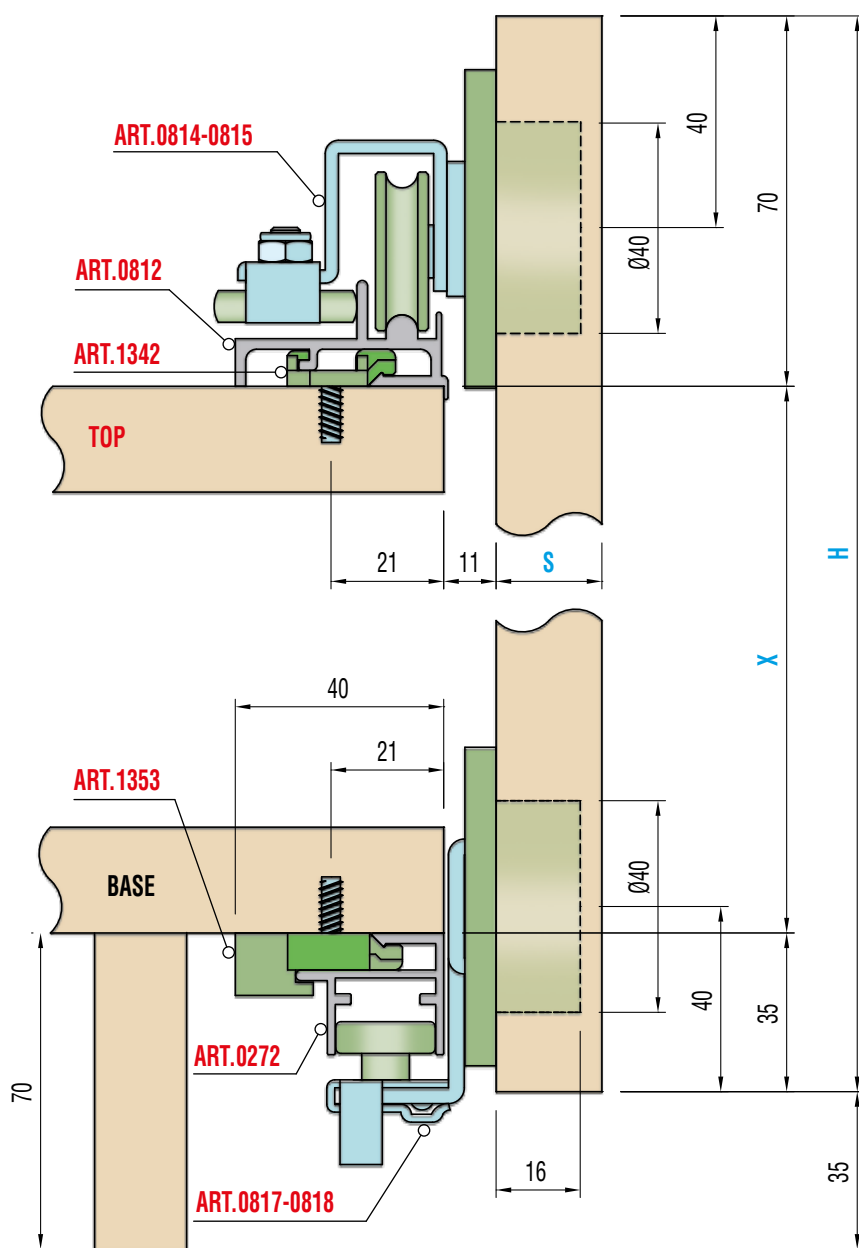

$$H = X + 105$$

S\* (spessore / thickness)  
min. 18 mm.

## Schema di foratura per art.1352 e art.1353 / Drilling for art.1352 and art.1353

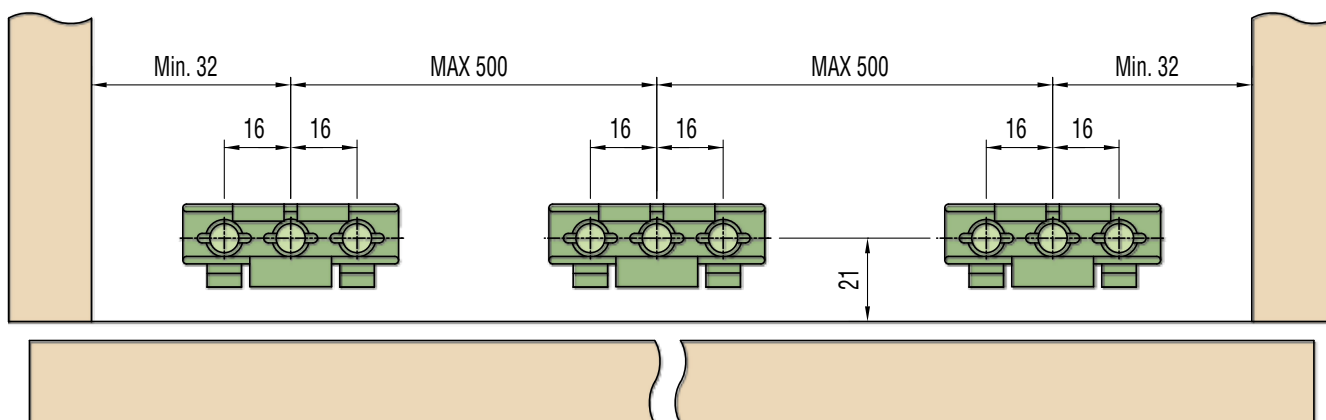



Sistemi scorrevoli per armadi / Folding systems for furniture

## Schema foratura ante / Doors drilling

CON GUIDA INFERIORE ALL'INTERNO DEL MOBILE / WITH LOWER RUNNER INSIDE THE WARDROBE

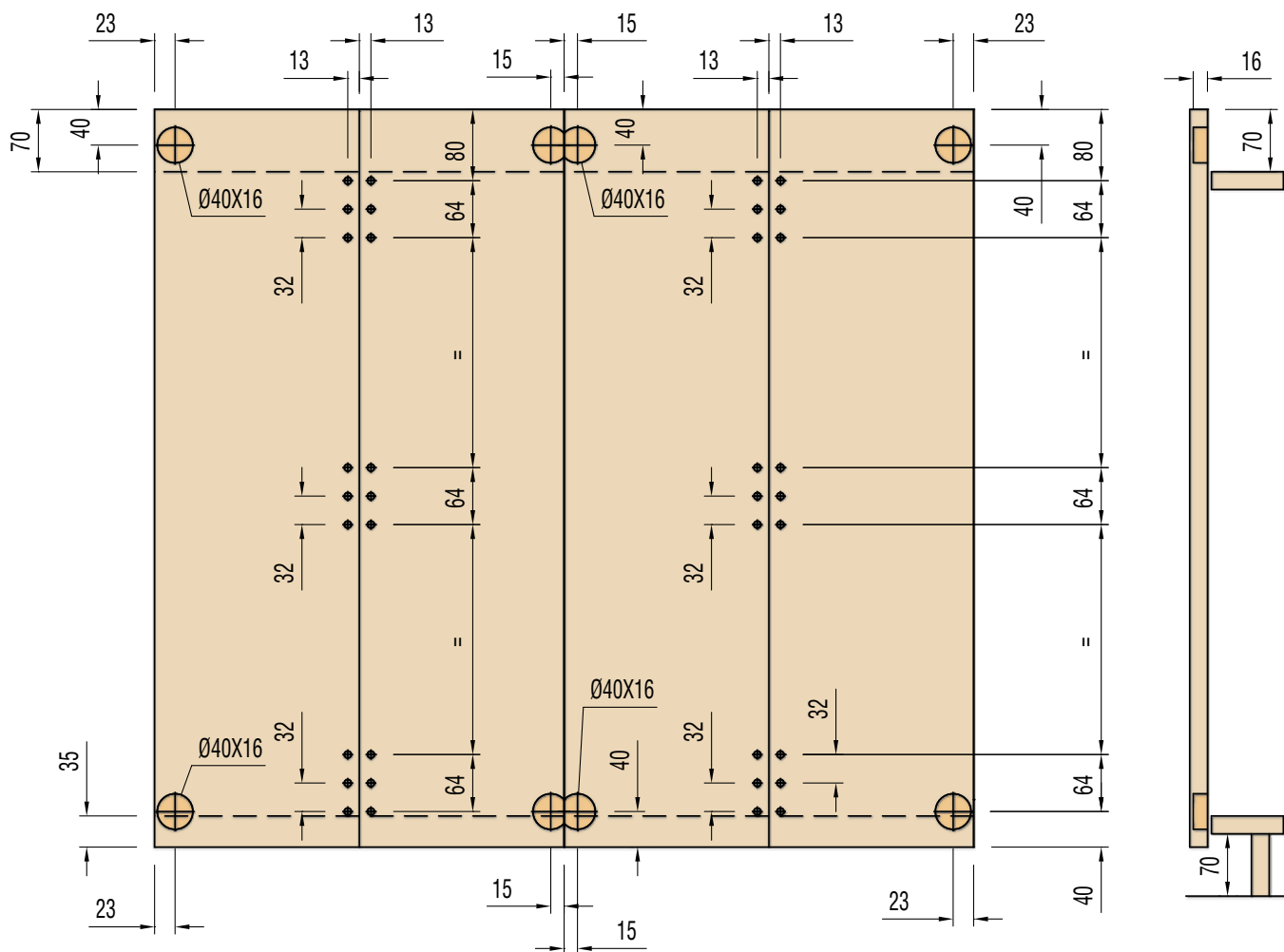

## Dimensione minima di ingombro / Minimum overall dimension

SISTEMA A QUATTRO ANTE / SYSTEM FOR FOUR DOORS

